

Foxtail Lane

Lot 7
(N88°44'41"E 101.75')
N88°45'34"E 101.66'

Arc=61.43'
Radius=65.00', Chord=N31°08'31"E 59.17'
(N31°09'05"E 59.18')

There are existing improvements on the property which are not shown as specified by the client.

Lot 8
Tax Parcel
FCV 00008
0.523 Acre
22,770 Sq.Ft.

10' Wide Utility Easement
As shown on the plat of Country View Subdivision.

S1°15'19"E 197.72'
(S1°15'19"E 197.68')

Tax Parcel
FD 2300002

15' Wide Drainage Easement
As shown on the plat of Country View Subdivision.

Lot 9

N25°37'10"W 242.24'
(S25°41'24"E 242.23')

20' Wide Drainage Easement
As shown on the plat of Country View Subdivision.

10' Wide Utility Easement
As shown on the plat of Country View Subdivision.

Lot 7
Lake Prairie
Subdivision

Line as shown on survey dated October 1, 1997 prepared by Peter L. Bailey, American Surveying Company, Inc.

Tax Parcel
FD 2300006

S23°23'03"W 80.19'
(S23°17'55"W 80.03')

Found second pipe
7.39' N24°30'34"E
of corner.

2" Pipe in
Pedestal

Plat of Survey

of

Lot 8 of Country View Subdivision,

located in the Southwest 1/4 of Section 23, Town 2 North, Range 16 East, Town of Delavan, Walworth County, Wisconsin.

Surveyed for: **Shorewest Realtors**
830 East Geneva Street
Delavan, Wisconsin. 53115

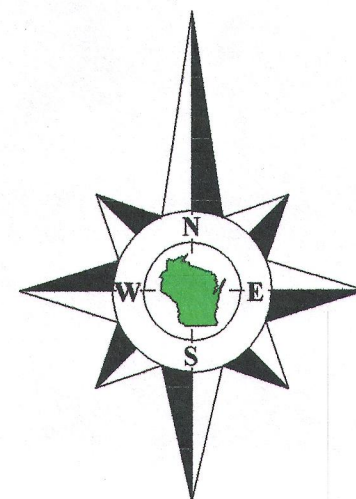

Bearings reference to the plat of Country View Subdivision.

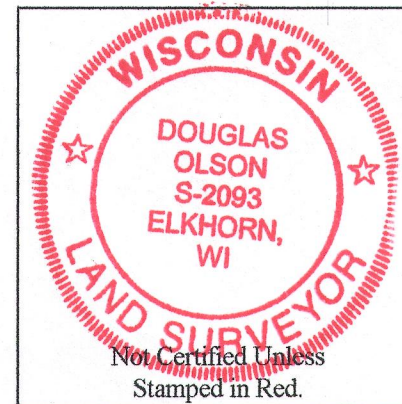

Notes:

- 1) This survey plat is not certified unless signed and sealed in red ink.
- 2) This survey is subject to Wisconsin lien laws. This Plat of Survey is the notice of intent to file lien. Lien waiver required.

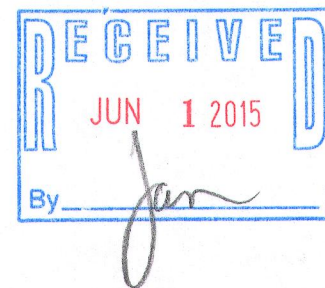

Copyright 2014 by Jensen & Olson Land Surveying, LLC.

All rights reserved. No part of this survey plat may be reproduced or transmitted in any form by any means - graphic, electronic, or mechanical, including photocopying, tracing, or information storage and retrieval systems - without permission in writing from Douglas G. Olson, Jensen & Olson Land Surveying, LLC.

I hereby certify that I have surveyed the above described property and the map hereon is correct to the best of my professional knowledge and belief and shows the size and location of the property, its exterior boundaries, the location and dimensions of all visible structures thereon, boundary fences, apparent easements and roadways and visible encroachments, if any.

This survey is made for the exclusive use of the present owners of the property, and also those who purchase, mortgage or guarantee title thereto, within one year from the date hereof.

Douglas G. Olson
Wisconsin Professional Land Surveyor - 2093

Survey Date: November 21, 2014.

Revisions:

Scale in Feet

1" = 20'



Jensen & Olson Land Surveying, LLC

45 South Wisconsin Street * P.O. Box 322 * Elkhorn, Wisconsin. 53121

Telephone: (262) 723-3434 * Facsimile: (262) 723-8044

Email: jensen.olson@elknet.net

Legend

Found Iron Pipe
() Recorded Information

Sheet 1 of 1 Sheets

Drawing Name: C:\w-2014\16-2014\16P\16P.dwg

Job Reference Number

2014.136

2014.136

FCV-8 216-5191